

MATERIAL NUMBER	ENGINEERING NUMBER	POLE	PIN CONFIGURATION
120070084	8R3L560005	3	STRAIGHT
1200700162	8R4L560005	4	STRAIGHT
1200700242	8R5L560005	5	STRAIGHT
1200700086	8R3L570005	3	90 DEGREE
1200700164	8R4L570005	4	90 DEGREE
1200700244	8R5L570005	5	90 DEGREE

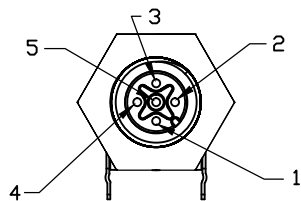

FACE VIEW
(STRAIGHT)

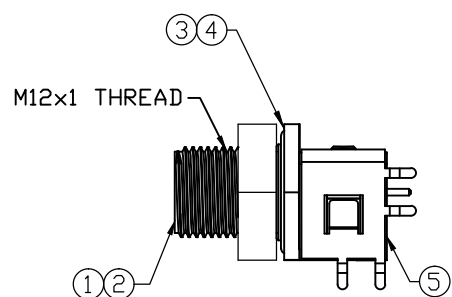

STRAIGHT PIN CONFIGURATION

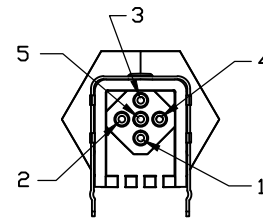

BACK VIEW
(STRAIGHT)

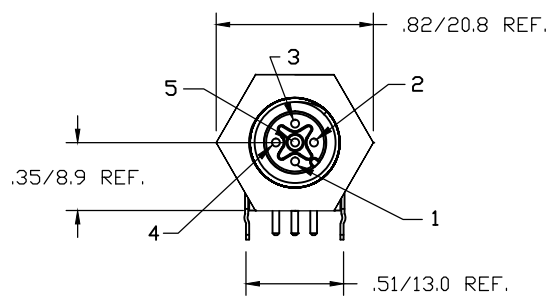
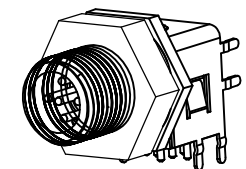

FACE VIEW
(90° CONFIG.)

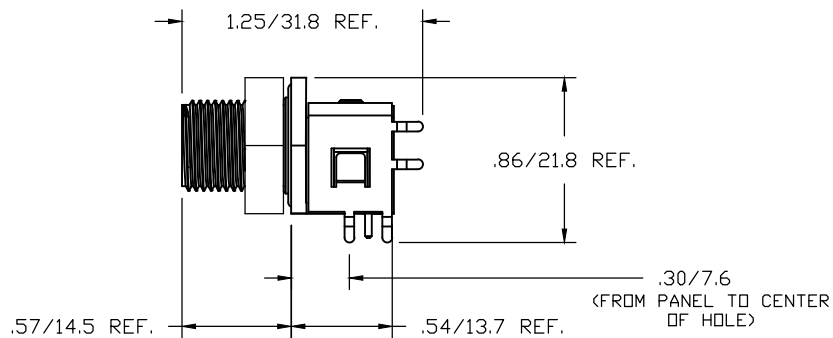

90° PIN CONFIGURATION

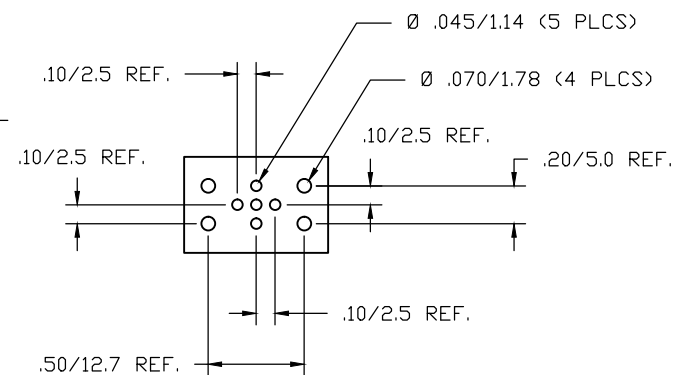

RECOMMENDED PCB LAYOUT
(BOTH STRAIGHT & 90°)

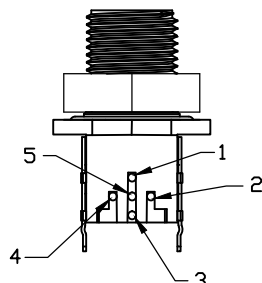

BOTTOM VIEW
(90° CONFIG.)

5 POLE SHOWN

NOTE:
PANEL THICKNESS - .14 MAX.

VOLTAGE RATING	250 VAC/VDC
AMPERAGE RATING	4 AMPS
PROTECTION	IP67
OPERATING TEMPERATURE	-20°C TO 80°C
PANEL HOLE CUT SIZE	Ø .51/12.9

ITEM	COMPONENT	MATERIAL	FINISH
1	INSERT	NYLON	BLACK
2	CONTACT PIN	COPPER ALLOY	GOLD OVER NICKEL
3	RECEPTACLE SHELL	DELTRIN	BLACK
4	O-RING	VITON	
5	BRACKET	STEEL	TIN PLATED

ADDED PART NUMBERS EC NO: IPG2015-1776 DRWN: GGUSTAFS 2015/04/13 CHKD: BARDEN 2015/05/29 APPR: BWOODMAN 2009/08/28	QUALITY SYMBOLS ▽=0 ◻=0	GENERAL TOLERANCES (UNLESS SPECIFIED)		DIMENSION STYLE IN/MM		SCALE 1:1	DESIGN UNITS INCH	THIRD ANGLE PROJECTION
		4 PLACES	±--	±---	DRAWN BY	DATE	TITLE M12 PCB MOUNT MALE 3P/4P/5P RECEPTACLE STR/90D	
		3 PLACES	±--	±.005	CHECKED BY	DATE		
		2 PLACES	±--	±.01	APPROVED BY	DATE		
1 PLACE	±0.3	±.02	JFMURPHY	2009/08/28				
ANGULAR ±1/2°		DRAFT WHERE APPLICABLE MUST REMAIN WITHIN DIMENSIONS		SEE CHART		MOLEX INCORPORATED		SHEET NO. 1 OF 1
MATERIAL NO.		THIS DRAWING CONTAINS INFORMATION THAT IS PROPRIETARY TO MOLEX INCORPORATED AND SHOULD NOT BE USED WITHOUT WRITTEN PERMISSION		DOCUMENT NO. SD-120070-009				